

Skills USA CAREER EXPO

MARCH 23-24, 2017

GEORGIA INTERNATIONAL CONVENTION CENTER, HALLS A,B,C,D
ATLANTA, GEORGIA

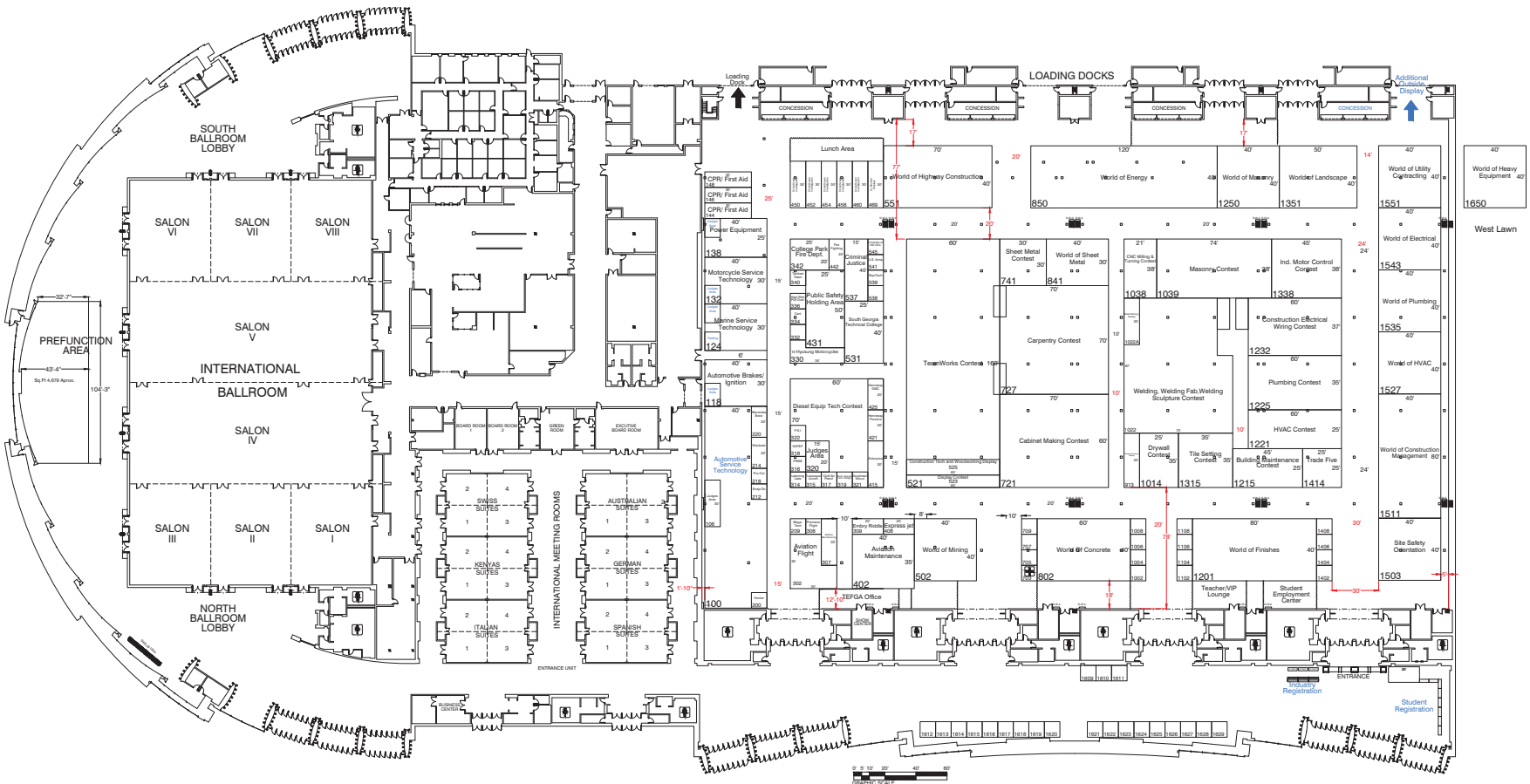

REVISION

Date: 3/15/2017

By: ---

BOOTH COUNT

Inventory as of 03/15/2017

Dimension	Size	Qty	SqFt
10x10	100	58	5,800
10x20	200	7	1,400
10x30	300	13	3,900
10x20	300	1	300
10x35	350	1	350
8x60	480	1	480
20x25	500	1	500
10x60	600	1	600
15x40	600	1	600
20x25	625	1	625
21x38	798	1	798
25x35	875	1	875
30x30	900	1	900
25x40	1,000	2	2,000
20x45	1,125	1	1,125
30x40	1,200	4	4,800
35x35	1,225	1	1,225
20x60	1,200	1	1,200
30x40	1,400	1	1,400
25x60	1,500	1	1,500
40x40	1,600	8	12,800
38x45	1,710	1	1,710
40x60	2,400	1	2,400
35x60	2,100	1	2,100
37x60	2,220	1	2,220
40x60	2,400	1	2,400
40x70	2,800	1	2,800
38x34	2,812	1	2,812
40x60	3,200	2	6,400
60x70	4,200	1	4,200
40x120	4,800	1	4,800
70x70	4,900	1	4,900
40x130	5,200	1	5,200
50x190	9,500	1	9,500
Custom	400	1	400
Custom	850	1	850
Custom	5,720	1	5,720
Totals:	124	101,340	

BLDG. LEGEND:

DRAWING INFO

Passport Line Item Number:

#3306949

Facility: GEORGIA INTERNATIONAL CONVENTION CENTER

Hall / Levels: HALLS A,B,C,D

City & State: ATLANTA, GEORGIA

Scale: Custom

Job #: 448379

AE: COLBY HAWKINS

Prod. AE: ---

Started: 2/27/2017

Started By: SERDC/MARTHA DE MATIZ

Branch: ATLANTA

FREEMAN

EVERY EFFORT HAS BEEN MADE TO ENSURE THE ACCURACY OF ALL INFORMATION CONTAINED ON THIS FLOORPLAN. HOWEVER, NO WARRANTIES, EITHER EXPRESSED OR IMPLIED, ARE MADE WITH RESPECT TO THE FLOORPLAN. IF THE LOCATION OF BUILDING COLUMNS, UTILITIES OR OTHER ARCHITECTURAL COMPONENTS OF THE FACILITY IS A CONSIDERATION IN THE CONSTRUCTION OR USAGE OF AN EXHIBIT, IT IS THE SOLE RESPONSIBILITY OF THE EXHIBITOR TO PHYSICALLY INSPECT THE FACILITY TO VERIFY ALL DIMENSION AND LOCATIONS. © COPYRIGHT 2017, FREEMAN CO. ALL RIGHTS RESERVED.

File Path: P:\Atlanta\Branch\SERDC\Floor Plans\Shows\2017\03_Mar Communion Educ Found of GA - 448379